

CASH® Multi Stunner

User manual



ORIGINAL INSTRUCTION MANUAL
©2020 Frontmatec Accles & Shelvocke Ltd



DO NOT ATTEMPT TO USE THESE STUNNING TOOLS UNTIL
YOU HAVE READ AND UNDERSTOOD THE USER MANUAL

SECTION	DESCRIPTION	PAGES
	CONTENTS	2
1	PRODUCT DESCRIPTION	3
2	PRODUCT SPECIFICATION	4
3	PRODUCT DIAGRAM	5
4	ANIMAL WELFARE	8
5	EFFECTIVE STUNNING & CARTRIDGE SELECTION	9
6	GENERAL SAFETY PRECAUTIONS	16
7	SAFE OPERATING INSTRUCTIONS	18
8	CLEANING & GENERAL MAINTENANCE	23
9	TROUBLESHOOTING	21
10	SERVICING	23
11	SPARE PARTS LIST AND DIAGRAM	29
12	CONTACT DETAILS, WARRANTY AND RECYCLING	30
	DECLARATION OF CONFORMITY CERTIFICATE	32

DISCLAIMER

This instruction manual is correct at the time of printing. However, because our policy is one of constant development and improvement, details and images may vary slightly from those provided in this publication.

© Copyright of Accles & Shelvoke Ltd 2020 - All rights reserved Accles & Shelvoke, **CASH®**, **CASH®** Multi Stunner are all trademarks of Accles & Shelvoke Ltd

ONLY EVER USE GENUINE ACCLES & SHELVOKE REPLACEMENT PARTS. NOT USING GENUINE PARTS MAY LEAD TO PREMATURE COMPONENT AND TOOL FAILURE, WHICH COULD ENDANGER THE OPERATOR AND THOSE IN THE IMMEDIATE VICINITY. IT WILL ALSO INVALIDATE OUR ORIGINAL EQUIPMENT WARRANTY.

ACCLES & SHELVOKE WILL ACCEPT NO LIABILITY IF ANY COMPONENTS OTHER THAN THOSE SUPPLIED BY ACCLES & SHELVOKE ARE USED WITH OUR ORIGINAL EQUIPMENT. THE RESULTANT LIABILITY WILL BE WITH THE END USER OR THE DISTRIBUTOR WHO SUPPLIED THE UNAPPROVED REPLACEMENT PARTS.

STUNNER SHOULD BE STORED IN A SECURE AND DRY CABINET WHEN NOT IN USE.

The **CASH®** Multi Stunner range of stunners are cartridge powered, contact firing, cylindrical style penetrative tools with automatic bolt return. They are available in .25" calibre and can be used to stun cattle, pigs and other large animals. These tools are intended for professional use.

Product	Product code	Product description	Calibre	Maximum permitted cartridge
CASH® Multi Stunner	5500	CASH® Multi Stunner .25R	0.25	3.5 grain (.25 ORANGE)

The **CASH®** Multi Stunner range of stunning tools are penetrative captive bolt devices which cause severe and irreversible damage to the brain. These tools are designed to stun all designated animals prior to slaughter or depopulation. They can be used in accordance with EU Council Regulation (EC) number 1099/2009 On the Protection of Animals at the Time of Killing.

The **CASH®** Multi Stunner range of tools are contact firing. This means that when the tool is in the cocked position and ready to fire, and the muzzle/barrel is depressed, the tool will fire and the bolt will exit the tool at a very rapid velocity. Maximum 3 shots per minute.

The **CASH®** Multi Stunner is a new tool on the market and is a derivative of the **CASH®** Cow Puncher that has earned a reputation for being a reliable and effective tool.

To ensure the safety of the operator, and quality of products, all Accles & Shelvoke stunning tools are proof tested in accordance with the Rules of Proof 2006. We have 'assistant proof masters' who are accredited by the British Proof House (formerly the Birmingham Proof House, www.gunproof.com). We work to standards set by the Commission Internationale Permanente pour l'Epreuve des Armes à Feu Portatives (CIP). All stunning tools are "Proofed" prior to the stunners being released to customers. Proofed components are stamped with the mark of the British Proof House, so that users can be assured of the quality and safety of the product.

Attribute	Stunner model number
	5500
Length (mm)	400
Width (mm) at widest point	70
Weight (kg)*	3.7 kg
"A" weighted Sound Pressure Level at work station (dB)	86
"A" weighted Sound Power level (dB)	80
"C" weighted peak emission (dB)	120
Calibre	.25
Chamber	Reduced

*Rounded to 1 decimal place

Sound values determined according to EN 15895 using EN ISO 3744, using the maximum rated cartridge for a given tool. Tests conducted using simulated load (paper sheets and plasticine).

The A-weighted sound pressure level and A-weighted sound power level have been calculated - and are hence valid - at the maximum number of driving processes in one second.

The maximum number of driving processes in the **CASH®** Multi Stunner tool is three per minute. This applies to all of the tools in the range included in this manual.

Information about vibrations

EN15895 states - for cartridge operated hand tools, the vibration total value to which the hand-arm system is subjected does not exceed 2.5m/s^2 . The generated mechanical recoil that is transmitted into the hand and arm of the operator is not considered to be a vibration.

CASH® Multi Stunner

FIG. 3.01

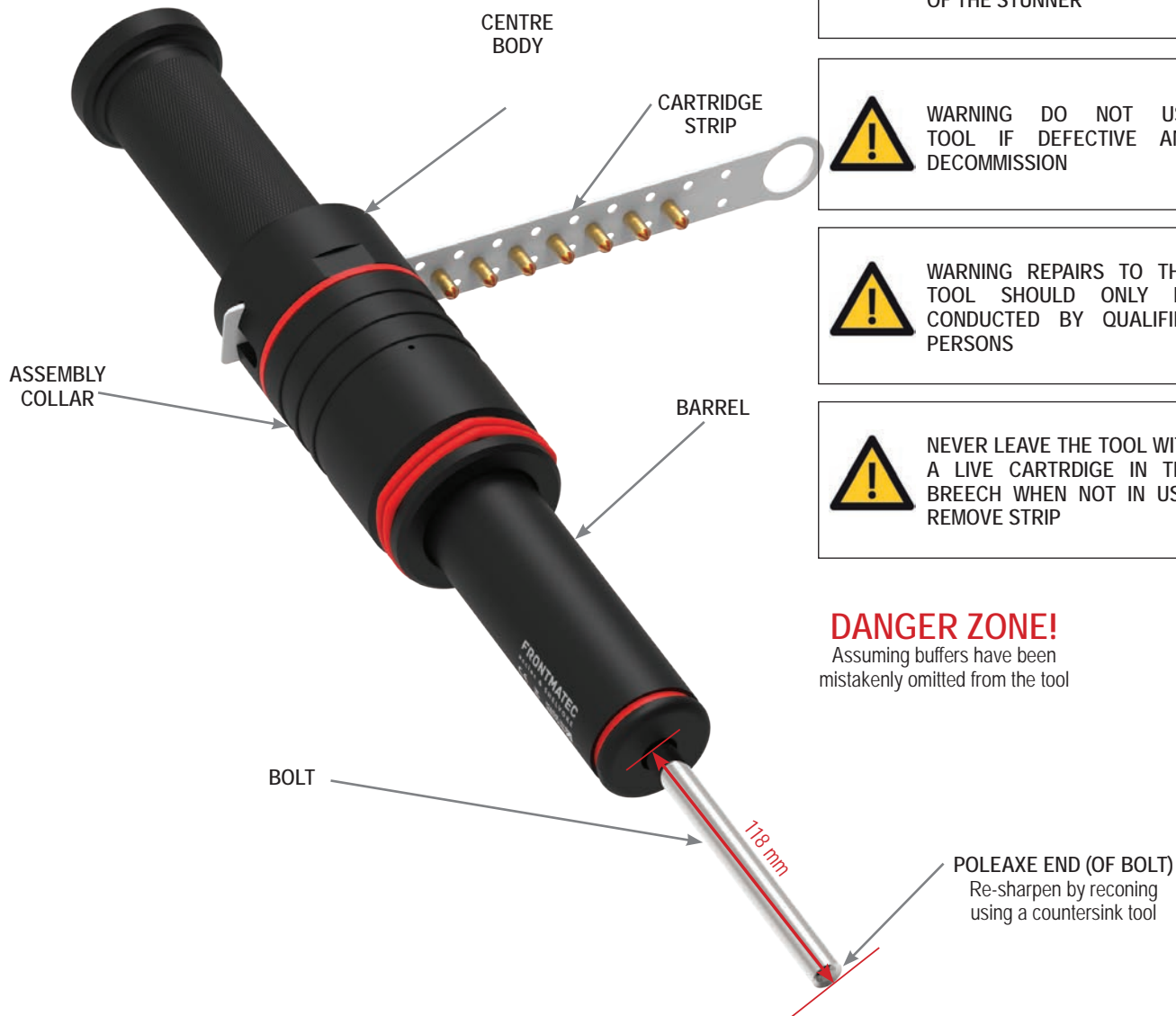

THE MAXIMUM GRAINS (GRN) AND SERIAL NUMBER OF THE TOOL CAN BE FOUND ENGRAVED ON THE BARREL OF THE STUNNER



WARNING DO NOT USE TOOL IF DEFECTIVE AND DECOMMISSION



WARNING REPAIRS TO THIS TOOL SHOULD ONLY BE CONDUCTED BY QUALIFIED PERSONS



NEVER LEAVE THE TOOL WITH A LIVE CARTRIDGE IN THE BREECH WHEN NOT IN USE. REMOVE STRIP

DANGER ZONE!

Assuming buffers have been mistakenly omitted from the tool

NOTE - every tool in the **CASH®** range is stamped with the maximum permitted (PROOF) cartridge, showing the maximum grains (GRN) that should be used.



NEVER USE A MORE POWERFUL CARTRIDGE THAN THE MAXIMUM PERMITTED CARTRIDGE AS STAMPED ON YOUR STUNNING TOOL



NEVER POINT THE BARREL END OF THE STUNNING TOOL AT YOURSELF OR ANY OTHER PERSON



DO NOT GRIND THE OUTSIDE DIAMETER OF THE BOLT

CUT-AWAY SECTION MODEL SHOWING BOLT FULLY RETRACTED

FIG. 3.01

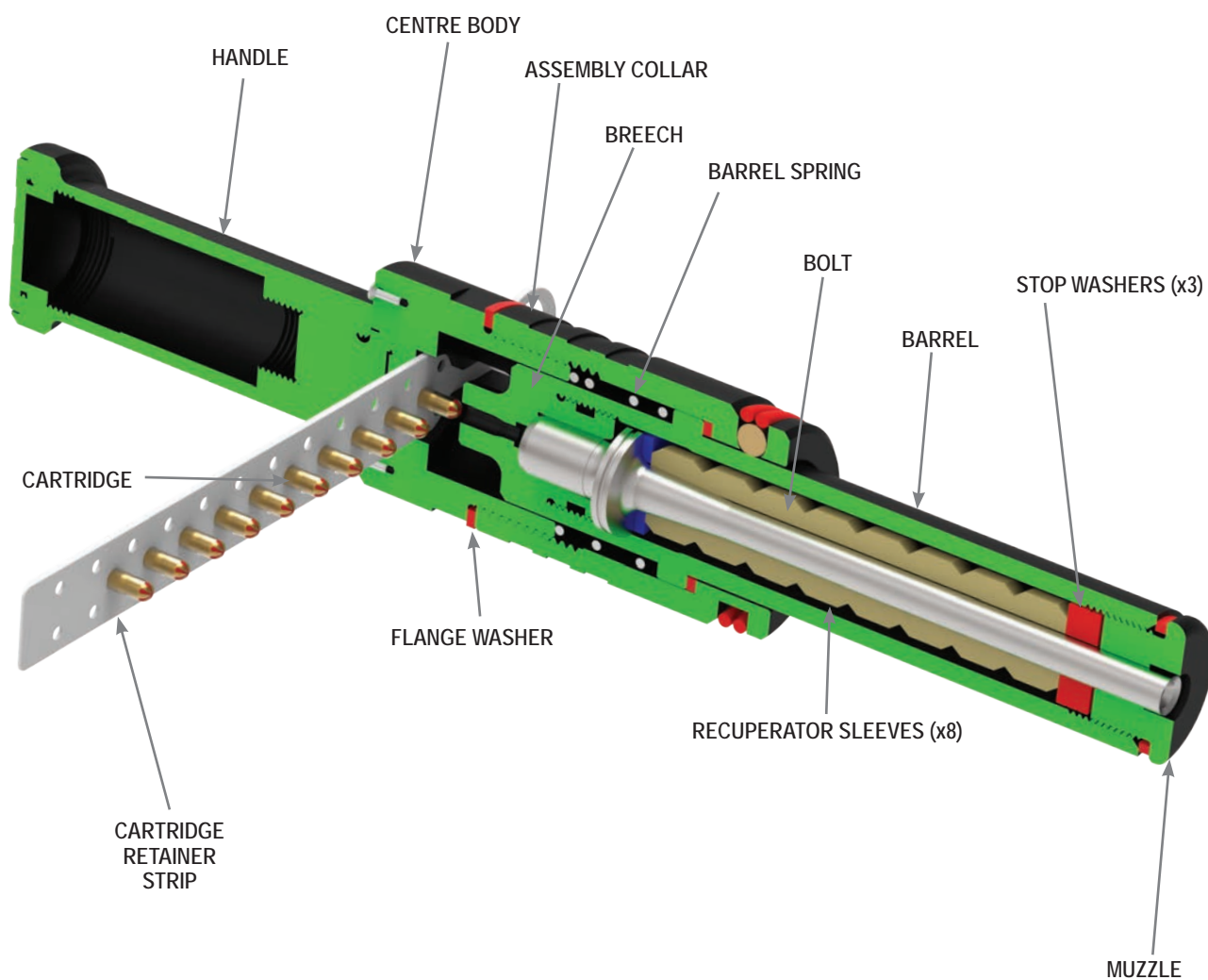
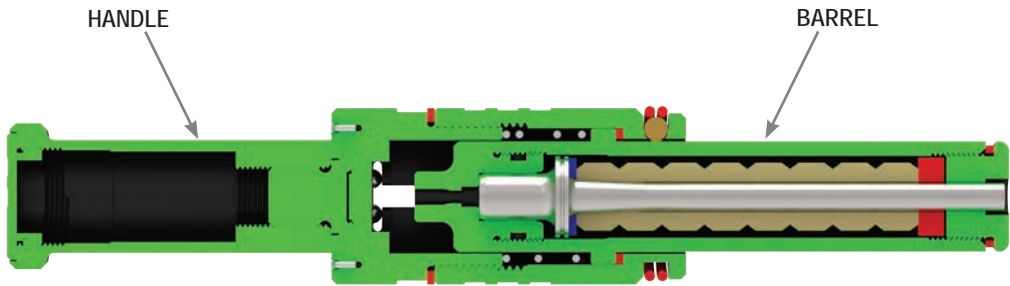

DIAGRAM SHOWING CAP AND BARREL SPLIT

FIG. 3.02



©2020 Frontmatec Accles & Shelvoke

FIG. 3.03

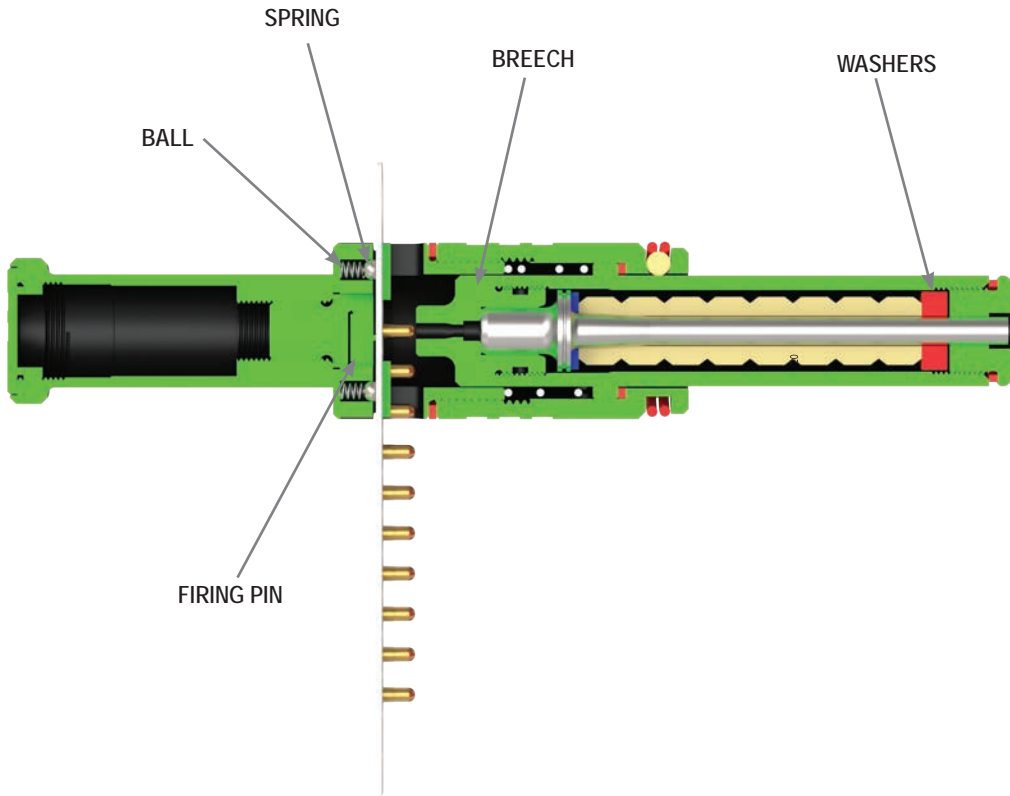

©2020 Frontmatec Accles & Shelvoke

Improving the protection of animals at the time of slaughter contributes to higher meat quality.

EU Only - in accordance with EU Council Regulation (EC) number 1099/2009 On the Protection of Animals at the Time of Killing, animals must be spared any avoidable pain, distress or suffering during their killing and related operations.

Business operators shall in particular take the necessary measures to ensure that animals:

- Are provided with physical comfort and protection, in particular by being kept clean, in adequate thermal conditions and prevented from falling or slipping
- Are protected from injury
- Are handled and housed taking into consideration their normal behaviour
- Do not show signs of avoidable pain or fear or exhibit abnormal behaviour
- Do not suffer from prolonged withdrawal of feed and water
- Are prevented from avoidable interaction with other animals that could harm their welfare

In addition:

- Bring the animal into the stun box only when the operator is ready to stun it
- Avoid excessive light and noise at the stun box to keep animal stress to a minimum
- The operator should not have to concentrate on keeping his balance, or have to bend excessively each time he stuns an animal, as this becomes tiring and can lead to inaccurate stunning. Stun box and race design is therefore of utmost importance for both animal welfare and the operator's health and safety
- The efficiency of each stunner is essential to ensuring an effective stun. Adhere to the cleaning and maintenance schedules detailed within this instruction manual
- Ensure at least 2 stunning tools are present near the stun box. If one stunner breaks down in use, then there must be a working second tool available, to ensure there is always a means of administering an effective stun to the target animal

NOTE - we always advise you to refer to any local regulations in force.

This section provides a guide to the correct stunning position and direction for certain animals, and helps you to select the correct cartridge for that animal.

The cartridge selection information provided within this section of this instruction manual is not categorical and is hence supplied as guidance only.

GOOD PRACTICE

- Understand animal welfare - refer to section 4 for further guidance
- Always ensure your stunning tool is in good working order
- Stunning tools should be cleaned and maintained in accordance with the instructions within this manual
- Ensure at least 2 stunning tools are present near the stunning box
- Stunning tools will require more maintenance if used with cartridges that are more powerful than is necessary for the target animal

EFFECTIVE STUNNING

The cartridge selection and the blow being applied to the correct part of the skull and in the right direction is important in ensuring an effective stun. Refer to the diagrams and selection charts within this section as guidance towards selection. To obtain maximum effect, the barrel of the tool must always be held firmly against the head.

The physical signs of an effective stun are:

Quadrupeds

- Animal collapses
- No rhythmic breathing
- Fixed, glazed expression in the eyes
- No corneal reflex
- Relaxed jaws
- Tongue hanging loose



THE EFFECTIVENESS OF THE STUN MUST BE VERIFIED BEFORE THE ANIMAL IS SLAUGHTERED

FAILURE TO STUN

If an animal is not properly stunned it must be re-stunned immediately. Using the second or an alternative stunning tool, a repeat shot must always be placed so as to avoid the immediate area of the first shot.

STUN-TO-BLEED TIMES

The humane killing of livestock using captive bolt equipment is a two-stage procedure. After the animal has been stunned, it must be bled (or pithed*) immediately to ensure rapid death.

The stun-to-stick interval is the time from application of stunning equipment to the start of bleeding. After stunning, sticking should be conducted without delay with a maximum stun-to-stick interval of 15 seconds recommended for all species in the field. In the abattoir, all pigs, sheep and goats should also be stuck within 15 seconds. However, on the majority of cattle lines, where the carcass must be hoisted to a bleed area, maximum stun-to-stick intervals of 60 seconds for the penetrative captive-bolt and 30 seconds for the non-penetrative captive-bolt are acceptable. (These figures are obtained from the Humane Slaughter Association (HSA) website).

*Dependant upon localised regulations in force.

CORRECT STUNNING POSITION
CATTLE

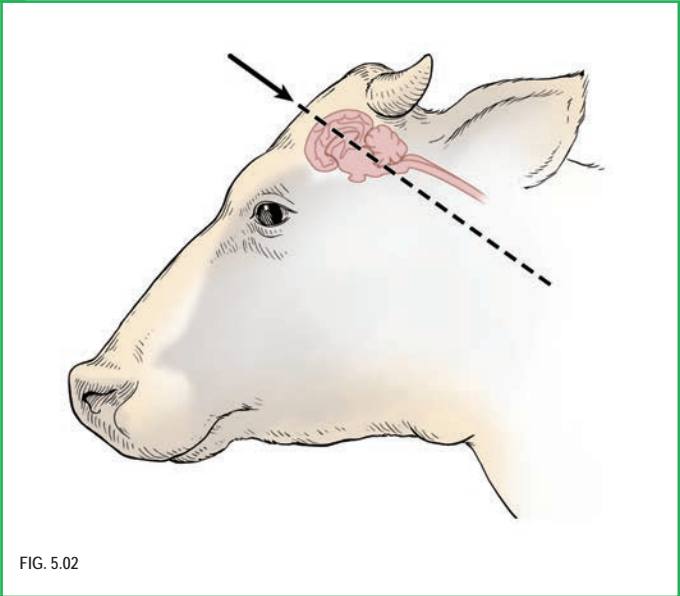
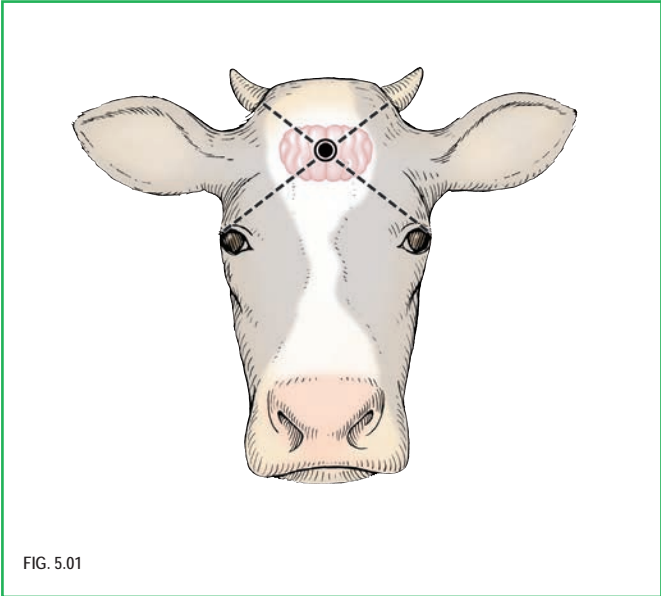

Illustration courtesy of J. K. Shearer, Iowa State University

	.25" range
	
For light animals	Yellow
For medium animals	Blue
For heavy animals and bulls	Orange
For very heavy animals	N/A
For extremely heavy animals	N/A

N/A: Not Applicable for denoted animal size

CORRECT STUNNING POSITION
PIGS

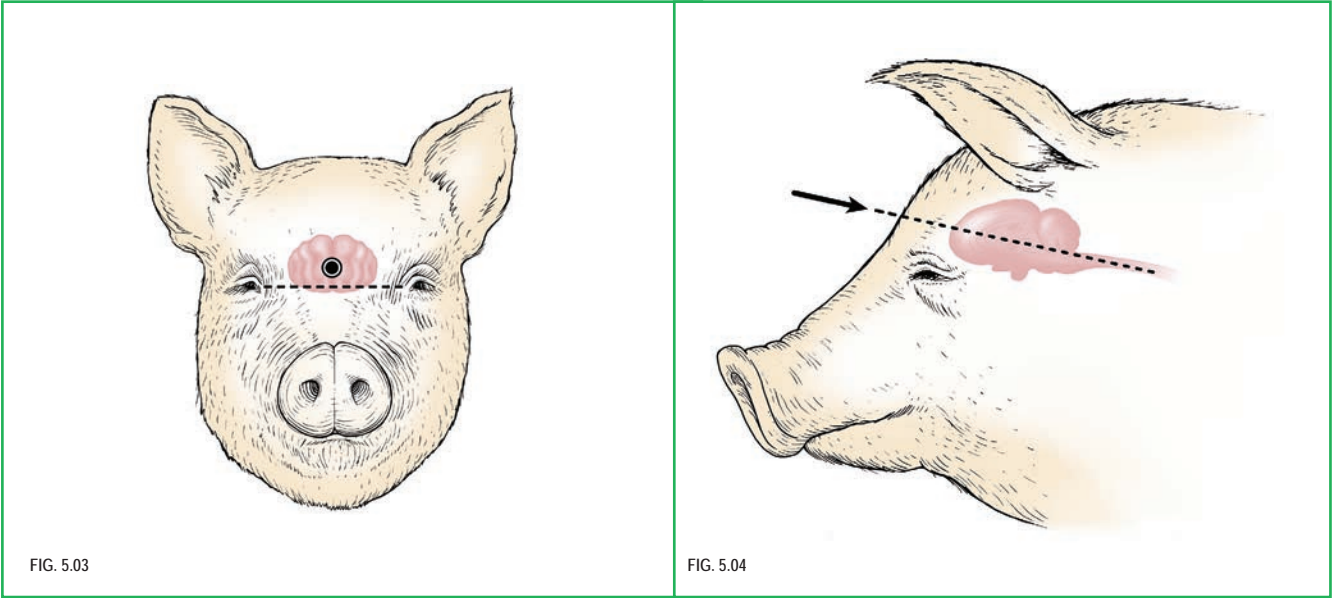

Illustration courtesy of J. K. Shearer, Iowa State University

	<div><div>.25" range</div></div>
For piglets	Pink
For weaners and growers	Yellow
For market pigs	Blue
For heavy animals	Orange
For heavy sows and boars	N/A
For extremely heavy animals	N/A

N/A: Not Applicable for denoted animal size

CORRECT STUNNING POSITION
SHEEP AND GOATS

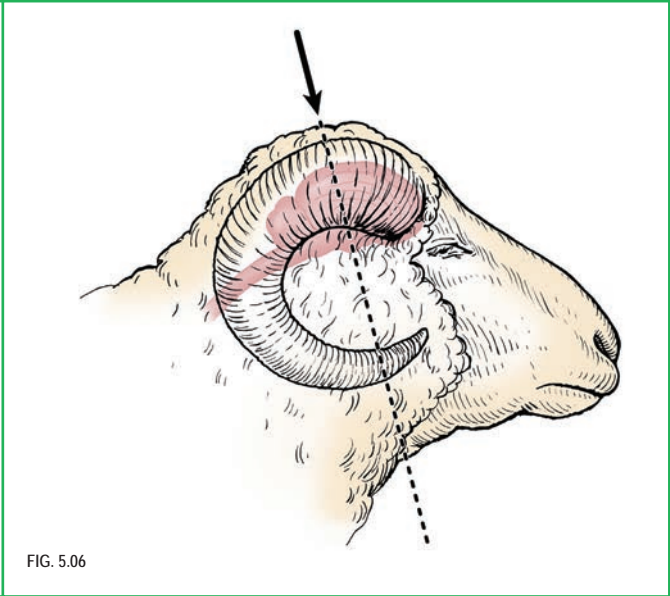
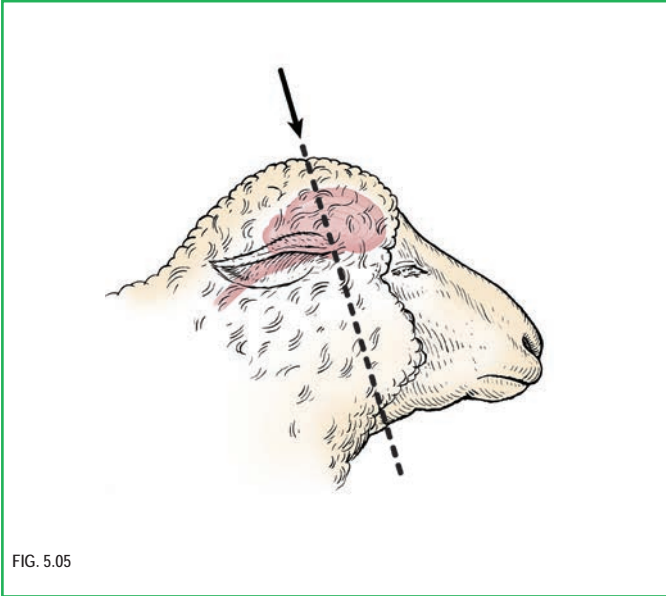

Illustration courtesy of J. K. Shearer, Iowa State University

	<div>.25" range</div> <div></div>
For small lambs and kids	Pink
For other lambs and kids	Pink
For ewes	Pink/Yellow
For rams	Yellow
For goats	Yellow

N/A: Not Applicable for denoted animal size

OTHER ANIMAL SPECIES

Although Accles & Shelvoke stunning tools are predominantly used for the stunning of cattle, sheep and pigs for meat production, we know from our 100 year history that they are also used for other animal species, such as, but not limited to:

Mammals such as

Equines
Deer
Camelids
Etc.

As conclusive test results are not available for these animals, we recommend you seek the advice of an independent expert to understand the appropriate cartridge selection, head placement and tool direction, prior to stunning.

ACCLES & SHELVOKE CARTRIDGE RANGE

The tables on the next pages identify which cartridges from our range are suitable for use with a given tool from the **CASH®** Multi Stunner range of products. The cartridges are supplied in quantities of 1000 in a box. All of our products will be clearly branded as Accles & Shelvoke **CASH®** cartridges. **CASH®** cartridges conform to EN16264.

It is a condition of Accles & Shelvoke's product liability insurance that only **CASH®** cartridges, in **CASH®** cartons and bearing "E" or "C" headmarks, be used in stunners manufactured by Accles & Shelvoke. It follows therefore, that no liability whatsoever can be accepted for any claim, including injury, should any other brand of cartridge be used.

Where cartridges other than these are used, Accles & Shelvoke will not accept responsibility for:

- The safety of the operator
- The humaneness of the stun
- The correct operation of the stunning tool
- The premature failure of parts

Cartridges must be stored in cool, dry conditions. Exposure to excessive amounts of moisture may affect cartridge performance, which in turn will affect tool performance with the potential to create an ineffective stun of the animal.

When not in use, cartridges should be locked away separately from any stunning tools.

NOTE - "N/A" - with reference to the compatibility tables in this section of the manual, "N/A" identifies that the cartridges highlighted are not applicable for use in the stated **CASH®** product in the table.



EXCEEDING THE PERMITTED STRENGTH OF CARTRIDGE COULD BE HAZARDOUS TO THE OPERATOR, WILL REDUCE THE EXPECTED LIFE OF THE TOOL OR ITS COMPONENTS AND WILL INVALIDATE OUR WARRANTY

CASH® Multi Stunner
EFFECTIVE STUNNING AND CARTRIDGE SELECTION

FRONTMATEC
accles & SHELVOKE

STUNNING TOOL AND CARTRIDGE COMPATABILITY - .25" CALIBRE

			Grain	1.25	2	3	3.5	4	4.5
Calibre	Product code	Description		Pink	Yellow	Blue	Orange	Black	Green
0.25"	5500	CASH® Multi Stunner .25		YES				NO	

PART NUMBERS FOR .25" CARTRIDGES BY QUANTITY

To order your .25" calibre cartridges, please select the appropriate part number from the table below:

Size/Grain	Colour	1000 in a box 10 per strip
	Pink	
2	Yellow	7710
3	Blue	7757
3.5	Orange	7748

ONLY EVER USE GENUINE ACCLES & SHELVOKE REPLACEMENT PARTS. THIS INCLUDES CARTRIDGES MARKED "AS" AND STRIPS PROVIDED. NOT USING GENUINE PARTS MAY LEAD TO PREMATURE COMPONENT AND TOOL FAILURE, WHICH COULD ENDANGER THE OPERATOR AND THOSE IN THE IMMEDIATE VICINITY. IT WILL ALSO INVALIDATE OUR ORIGINAL EQUIPMENT WARRANTY.

KEY PARAMETERS FOR CARTRIDGE SELECTION

The table on this page details the key performance parameters for the **CASH®** Multi Stunner when used in conjunction with approved Accles & Shelvoke cartridges.

This information is issued to satisfy the requirements of EU Council Regulation (EC) number 1099/2009 On the Protection of Animals at the Time of Killing. It provides guidelines to aid the selection of an appropriate cartridge to perform effective killing on a particular type and size of animal. Whilst we believe this regulation is open to interpretation, these parameters have been published following years of experience.

These figures may only be used when quoted with the associated notes. Accles & Shelvoke will not accept responsibility for the reliability of these figures if used out of context.

Product code	Calibre	Cartridge grains (nominal)	Frontmatec Accles & Shelvoke cartridge colour	#Bolt (head) diameter (mm)	Average bolt velocity* (m/s)	Minimum bolt exit length** (mm)	Energy generated (J)
5500	.25"		Pink	11.4		65	
		2	Yellow		47.2		273
		3	Blue		50.8		316
		3.5	Orange		53.1		345

NOTES

Bolt shank and head diameters quoted
* When measured in air over a distance of 47 mm, 15 mm from the muzzle tip of the tool
** When fired in air
These quoted figures have been established during extensive testing at the Accles & Shelvoke factory test facility.
The velocity figures quoted are accurate within +/- 15%, when using a stunning tool that is in good condition and maintained in accordance with this manual.



DANGER

ONLY COCK THE TOOL READY FOR FIRING IMMEDIATELY BEFORE USE
 IF DROPPED WHEN COCKED THIS TOOL COULD CAUSE SERIOUS INJURY OR DEATH



DO NOT ATTEMPT TO USE THIS STUNNING TOOL UNTIL YOU HAVE READ AND UNDERSTOOD THESE INSTRUCTIONS



- ALWAYS WEAR THE CORRECT PERSONAL PROTECTIVE EQUIPMENT (PPE) WHENEVER YOU ARE WORKING WITH, CLEANING OR MAINTAINING YOUR **CASH®** MULTI STUNNER TOOL
- ALWAYS WEAR PROTECTIVE GLASSES AND HEARING PROTECTION. THE CORRECT FOOT PROTECTION MUST BE WORN THERE IS A RISK THAT IF THE TOOL IS DROPPED, THE BOLT MAY PENETRATE THE FOOT OF THE TOOL USER



- ALWAYS WASH HANDS AFTER USING THE STUNNING TOOL TO ENSURE CLEANLINESS

GENERAL SAFETY STATEMENT

- THE INTENDED USE OF THIS TOOL IS FOR THE KILLING OF SMALL ANIMALS AND POULTRY
- ANYONE GRANTED THE AUTHORITY TO USE ONE OF THESE TOOLS SHOULD HAVE READ THIS MANUAL SUCH THAT THEY ARE MADE FULLY AWARE OF THE POTENTIAL RISKS
- THIS TOOL HAS THE POTENTIAL TO CAUSE SEVERE INJURY OR FATALITY IF USED IMPROPERLY OR INAPPROPRIATELY OUTSIDE OF ITS INTENDED SCOPE OF USE



DANGER - The hazards listed in this section pose a high level of risk which, if not avoided, will result in death or serious injury

- NEVER POINT THE TOOL AT YOURSELF OR ANY OTHER PERSON - THE BOLT WILL DELIVER A VERY HARMFUL BLOW WHICH MAY LEAD TO SEVERE AND IRREVERSIBLE DAMAGE, POSSIBLY LEADING TO FATALITY
- NEVER FIRE THE TOOL IN AN AREA DESIGNATED AS FLAMMABLE OR CONTAINING EXPLOSIVES
- NEVER PASS THE TOOL TO ANY OTHER PERSON WHEN IT IS COCKED AND READY TO FIRE - ACCIDENTAL FIRING OF THE BOLT MAY DELIVER A VERY HARMFUL BLOW WHICH MAY LEAD TO SEVERE AND IRREVERSIBLE DAMAGE POSSIBLY LEADING TO FATALITY
- NEVER LEAVE A CARTRIDGE, WHETHER LIVE OR FIRED, IN THE BREECH - TO PREVENT ACCIDENTAL FIRING OF THE BOLT
- TOOLS SHOULD BE FIRED AS FAR AWAY FROM THE BODY AS IS COMFORTABLE AND ALWAYS POINTING AWAY FROM THE OPERATOR - FIRING OF THE BOLT TOWARD BODY PARTS MAY DELIVER A VERY HARMFUL BLOW WHICH MAY LEAD TO SEVERE AND IRREVERSIBLE DAMAGE, POSSIBLY LEADING TO FATALITY
- NEVER MODIFY OR CUSTOMISE THE TOOL - THIS MAY RENDER THE TOOL UNSTABLE AND UNSAFE FOR USE, WITH THE POTENTIAL TO FIRE ACCIDENTALLY. IT WILL ALSO INVALIDATE YOUR WARRANTY
- ENSURE YOU ARE BALANCED AND STABLE PRIOR TO FIRING TO AID TOOL POSITIONING ACCURACY. AVOID OVER-STRETCHING AND UNFAVOURABLE BODY POSITIONS - TO MINIMISE THE RISK OF DROPPING THE TOOL AND/OR ACCIDENTAL FIRING
- CARTRIDGE MISFIRES - IF THE CARTRIDGE HAS MISFIRED (NOT FIRED), PUT THE TOOL DOWN IMMEDIATELY AND WAIT FOR 30 SECONDS BEFORE FOLLOWING THE PROCEDURE IN SECTION 9 OF THIS MANUAL - TO AVOID DELAYED FIRING OF THE CARTRIDGE - WHICH MAY CAUSE SEVERE DAMAGE IF FIRING OCCURS WHILST BEING HANDLED
- NEVER LOAD A LIVE CARTRIDGE INTO THE BREECH UNTIL POINTING AT THE ANIMAL'S HEAD. (SEE CORRECT STUNNING POSITION IN MANUAL)



- ALWAYS WEAR THE CORRECT PERSONAL PROTECTIVE EQUIPMENT (PPE) WHENEVER YOU ARE WORKING WITH, CLEANING OR MAINTAINING YOUR **CASH®** MULTI STUNNER TOOL
- ALWAYS WEAR PROTECTIVE GLASSES AND HEARING PROTECTION. THE CORRECT FOOT PROTECTION MUST BE WORN THERE IS A RISK THAT IF THE TOOL IS DROPPED, THE BOLT MAY PENETRATE THE FOOT OF THE TOOL USER



DANGER - If the tool is set in the cocked (ready to fire) position and is dropped, there is a potential risk to the operator and/or people within the immediate vicinity of the dropped tool. The hazards listed in this section pose a high level of risk, which if not avoided will result in serious injury

- IF IT DROPS AND LANDS ON THE TRIGGER, THE TOOL WILL FIRE AND THE BOLT WILL BE PROPELLED OUT OF THE TOOL AT A VERY HIGH VELOCITY. THE BOLT HAS THE POTENTIAL TO WILL DELIVER A VERY PAINFUL BLOW TO THE FEET OR LEGS IF THEY ARE WITHIN 75 MM OF THE BOLT WHEN IT FIRES OUT OF THE TOOL THEY ARE HIDDEN FROM PUBLIC VIEW, ie NO-ONE OUTSIDE OF THE VEHICLE CAN SEE THE LOCKABLE CONTAINERS WITHIN THE VEHICLE

Our advise to minimise the risk

- IF THE TOOL IS DROPPED, LET IT FALL, DO NOT TRY TO CATCH IT
- STEP AS FAR AWAY (AS IT IS SAFE TO) FROM THE TOOL AS IT FALLS, BUT WATCH IT HIT THE FLOOR
- TAKE APPROPRIATE AVOIDABLE ACTION IF TOOL REBOUNDS
- DO NOT APPROACH THE TOOL UNTIL IT IS STATIONARY
- AFTER BEING DROPPED, CHECK THAT THE CONCUSSION HEAD OF THE BOLT IS NOT DAMAGED
- ENSURE THE TOOL IS WORKING CORRECTLY BEFORE RECOMMENCING USE
- IF IN DOUBT, THE TOOL SHOULD BE CHECKED AND REPAIRED AS NECESSARY



WARNING - The hazards listed in this section pose a medium level of risk which, if not avoided may result in recoverable injury

- DO NOT FIRE THE BOLT INTO HARD, BRITTLE OR IMPENETRABLE MATERIALS - AS THE BOLT MAY aFRAGMENT AND POSE A DANGER OF FLYING PARTICLES
- NEVER USE A MORE POWERFUL CARTRIDGE THAN THE MAXIMUM PERMITTED CARTRIDGE AS STAMPED ON YOUR TOOL - TO PREVENT CARTRIDGE BURST AND EXCESSIVE NOISE IN OPERATION
- KEEP THE TOOL DRY AND CLEAN - TO ENSURE YOU HAVE AN ADEQUATE GRIP ON THE TOOL DURING USE AND MINIMISE THE RISK OF DROPPING THE TOOL
- WHEN PLACING THE ASSEMBLED TOOL – OR IF THE TOOL HAS BEEN SEPARATED THE CAP OR BARREL (REFER TO FIG 3.01) – DOWN ONTO A WORK SURFACE ENSURE THERE IS A MEANS TO PREVENT THE TOOL OR TOOL PARTS FROM ROLLING OFF THE WORK SURFACE. IF THE TOOL FALLS OR DROPS FROM THE WORK SURFACE, IT MAY DROP ONTO THE FOOT OF THE OPERATOR OR OTHER PEOPLE IN THE VICINITY



CAUTION - The hazards listed in this section pose a low level of risk which, if not avoided may result in minor or moderate injury

- TO AVOID TRAPPING FINGERS OR OTHER PARTS OF THE HAND WHEN ASSEMBLING THE CAP TO THE BARREL, HOLD THE CAP ABOVE THE RED O-RINGS IN THE KNURLED AREA ON THE HANDLE
- WHEN PLACING THE STUNNER DOWN ENSURE IT CANNOT ROLL OF THE WORK AND DROP OFF ONTO THE FLOOR AS THIS MAY DAMAGE THE STUNNER AND THE CARTRIDGE STRIP



- ALWAYS WEAR THE CORRECT PERSONAL PROTECTIVE EQUIPMENT (PPE) WHENEVER YOU ARE WORKING WITH, CLEANING OR MAINTAINING YOUR **CASH®** MULTI STUNNER TOOL
- ALWAYS WEAR PROTECTIVE GLASSES AND HEARING PROTECTION. THE CORRECT FOOT PROTECTION MUST BE WORN THERE IS A RISK THAT IF THE TOOL IS DROPPED, THE BOLT MAY PENETRATE THE FOOT OF THE TOOL USER



ALWAYS POINT THE TOOL AWAY FROM YOUR BODY AND AWAY FROM ANY OTHER PERSON IN THE VICINITY WHEN HANDLING OR OPERATING THE TOOL

GENERAL PRECAUTIONS AND GOOD PRACTICE

Improper use

- ONLY EVER USE THIS TOOL FOR THE STUNNING OF LIVE ANIMALS
- ONLY EVER USE GENUINE ACCLES & SHELVOKE SUPPLIED CARTRIDGES AND SPARES
- DO NOT FIRE "AIR SHOTS" (FIRING OF THE BOLT INTO AIR) AS THIS WILL REDUCE THE WORKING LIFE OF THE TOOL AND ITS COMPONENTS

Workplace precautions

- THE TOOL SHOULD BE USED IN WELL ILLUMINATED AND WELL VENTILATED WORKPLACE ENVIRONMENTS
- KEEP THE WORKPLACE CLEAN AND CLEAR OF UNNECESSARY OBSTACLES OR TRIP HAZARDS
- ENSURE THE AREA SURROUNDING THE STUN BOX IS FREE OF SLIPPERY SUBSTANCES. THESE ARE POTENTIAL SLIP HAZARDS TO THE OPERATOR WHICH COULD LEAD TO SERIOUS INJURY OR FATALITY IF THE OPERATOR SLIPS WHILST HOLDING A COCKED TOOL

Operational precautions

- ONLY LOAD CARTRIDGES WHEN THEY ARE READY TO BE USED
- IF A CARTRIDGE STICKS IN THE BREECH AND WILL NOT EJECT, DO NOT USE A SHARP INSTRUMENT TO REMOVE IT. THE TOOL SHOULD BE REMOVED IN ACCORDANCE WITH THESE INSTRUCTIONS IN SECTION 9 - TROUBLESHOOTING
- MORE THAN ONE TOOL MAY BE USED
- JOB ROTATION MAY HELP MAINTAIN THE APPROPRIATE HIGH LEVELS OF CONCENTRATION REQUIRED AT THE WORKPLACE, HELPING TO MINIMISE ANY RISK DUE TO TIREDNESS OR FATIGUE
- ALWAYS USE THE STUNNER BY HOLDING THE HANDLE PROVIDED
- ENSURE YOU NEVER BLOCK OR PUT HANDS NEAR WHERE THE CARTRIDGE STRIP ENTERS OR LEAVES THE TOP BREECH SLOT

Good practice

- THE CLEANING AND MAINTENANCE SCHEDULE DETAILED IN THIS MANUAL SHOULD BE ADHERED TO, TO ENSURE THE TOOL OPERATES SAFELY AND CORRECTLY TO PROVIDE EFFECTIVE ANIMAL STUNNING
- AT THE END OF A WORKING SHIFT, OR IF THE TOOL IS NOT GOING TO BE USED FOR PROLONGED PERIODS, THE UNCOCKED AND UNLOADED TOOL SHOULD BE STORED IN COOL DRY CONDITIONS AND LOCKED SECURELY IN A WAY THAT NO UNAUTHORISED ACCESS TO THE TOOL IS POSSIBLE
- CARTRIDGES SHOULD BE LOCKED AWAY SEPARATELY FROM THE STUNNING TOOL IN COOL, DRY CONDITIONS
- EXPOSURE TO EXCESSIVE AMOUNTS OF MOISTURE MAY AFFECT CARTRIDGE PERFORMANCE WHICH IN TURN WILL AFFECT TOOL PERFORMANCE, WITH THE POTENTIAL TO CREATE AN INEFFECTIVE STUN OF THE ANIMAL. WET CARTRIDGES WILL NOT FIRE AND SHOULD NOT BE USED
- ALWAYS WASH YOUR HANDS AFTER USING ANY STUNNING TOOL TO ENSURE CLEANLINESS
- IT IS ADVISABLE, BEFORE USING YOUR **CASH®** MULTI STUNNER TOOL FOR THE FIRST TIME, TO FAMILIARISE YOURSELF WITH THE ASSEMBLY OF THE CAP TO THE BARREL AND THE SUBSEQUENT ALIGNMENT OF THE RED DOTS TO COCK THE TOOL (MAKE READY FOR FIRING) AND ALSO TO PRACTISE TARGET ALIGNMENT TO ASSIST WITH TOOL PLACEMENT ACCURACY

Transportation of stunning tools and cartridges between sites

THIS TOOL HAS BEEN SUPPLIED TO YOU WITH THE INTENTION OF SINGLE SITE USE - SUPPLIED WITHOUT A LOCKABLE STORAGE CONTAINER. SHOULD THERE BE A NEED TO TRANSPORT THIS TOOL AND LIVE CARTRIDGES BY ROAD BETWEEN SITES, WE ADVISE:

- PRIOR TO TRANSPORTATION, YOU SHOULD SEEK THE APPROPRIATE ADVICE CONCERNING APPLICABLE LOCAL LAWS AND REGULATIONS IN FORCE ON THE TRANSPORTATION OF CARTRIDGES TO BE USED FOR ANIMAL STUNNING
- THE TOOL AND CARTRIDGES ARE TRANSPORTED IN SEPARATE LOCKABLE CONTAINERS
- THEY ARE HIDDEN FROM PUBLIC VIEW, ie NO-ONE OUTSIDE OF THE VEHICLE CAN SEE THE LOCKABLE CONTAINERS WITHIN THE VEHICLE



DANGER

ONLY COCK THE TOOL READY FOR FIRING IMMEDIATELY BEFORE USE
IF DROPPED WHEN COCKED THIS TOOL COULD CAUSE SERIOUS INJURY OR DEATH





DO NOT ATTEMPT TO USE THIS STUNNING TOOL UNTIL YOU HAVE READ AND UNDERSTOOD THESE INSTRUCTIONS



- ALWAYS WEAR THE CORRECT PERSONAL PROTECTIVE EQUIPMENT (PPE) WHENEVER YOU ARE WORKING WITH, CLEANING OR MAINTAINING YOUR **CASH®** MULTI STUNNER TOOL
- ALWAYS WEAR PROTECTIVE GLASSES AND HEARING PROTECTION. THE CORRECT FOOT PROTECTION MUST BE WORN THERE IS A RISK THAT IF THE TOOL IS DROPPED, THE BOLT MAY PENETRATE THE FOOT OF THE TOOL USER



ALWAYS POINT THE TOOL AWAY FROM YOUR BODY AND AWAY FROM ANY OTHER PERSON IN THE VICINITY WHEN HANDLING OR OPERATING THE TOOL



AT THE END OF A WORKING SHIFT, OR IF THE TOOL IS NOT GOING TO BE USED FOR PROLONGED PERIODS, THE UNCOCKED AND UNLOADED TOOL SHOULD BE STORED IN COOL DRY CONDITIONS AND LOCKED SECURELY IN A WAY THAT NO UNAUTHORISED ACCESS TO THE TOOL IS POSSIBLE

1. PREPARING FOR LOADING

- 1.1 Hold the tool on the handle
- 1.2 Pull strip to load first cartridge (fig. 7.01)

NOTE

- The maximum recommended usage rate for a **CASH®** Multi Stunner tool is 20 0 shots per hour using the maximum specified cartridge
- If spent cartridge is stuck in the chamber do not attempt to remove it by prising out with a sharp implement or improvised extraction tool. ONLY use extraction tool provided



DANGER

ONLY COCK THE TOOL READY FOR FIRING IMMEDIATELY BEFORE USE
IF DROPPED WHEN COCKED THIS TOOL COULD CAUSE SERIOUS INJURY OR DEATH





ALWAYS POINT THE TOOL AWAY FROM YOUR BODY AND AWAY FROM ANY OTHER PERSON IN THE VICINITY WHEN HANDLING OR OPERATING THE TOOL

2. LOADING

2.1 Feed the cartridge strip into the side of the multi stunner (fig. 7.01/fig. 7.02)

2.2 Keep the muzzle pointing downward when loading

NOTE

- Only load the cartridge immediately before firing
- Keep the cartridge clean and dry before insertion into the chamber
- Ensure cartridge head is flat on breech face
- Only use the correct grade of **CASH®** cartridge, as shown in fig. 7.05
- When not in use, never leave a cartridge in the chamber whether live or spent
- Never leave a loaded stunner unattended
- Bolt when returned should be 3 mm recessed (fig. 7.03)

FIG. 7.01



FIG. 7.02

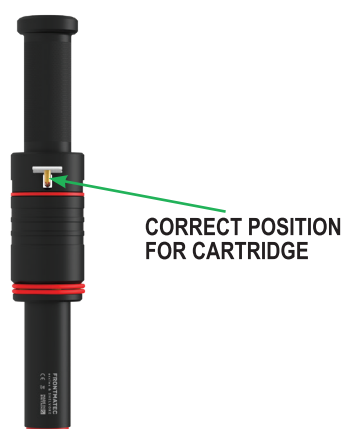

FIG. 7.03

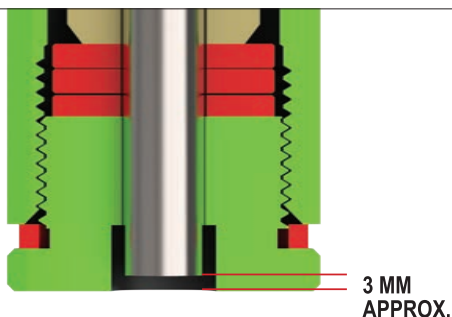

FIG. 7.04

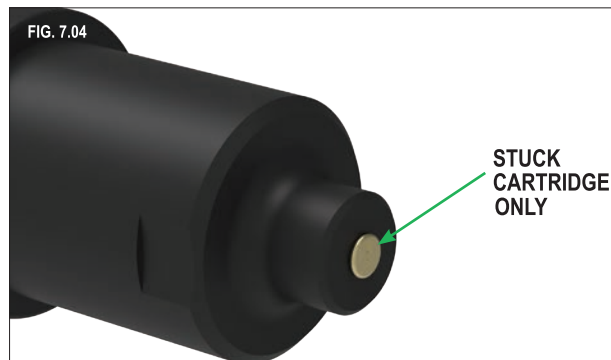
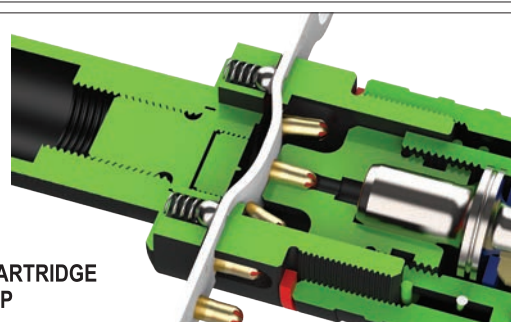

FIG. 7.05



ONLY USE **CASH®** CARTRIDGES
WITH **CASH®** STUNNING TOOLS

FIG. 7.06



DANGER

ONLY COCK THE TOOL READY FOR FIRING IMMEDIATELY BEFORE USE
IF DROPPED WHEN COCKED THIS TOOL COULD CAUSE SERIOUS INJURY OR DEATH





ALWAYS POINT THE TOOL AWAY FROM YOUR BODY AND AWAY FROM ANY OTHER PERSON IN THE VICINITY WHEN HANDLING OR OPERATING THE TOOL

3. MAKE READY FOR FIRING

3.1 With the tool facing away from you and the barrel pointing downward, slot the cartridge strip into the multi stunner



WARNING - AT THIS POINT THE **CASH®** MULTI STUNNER IS LOADED AND READY TO FIRE. ANY PRESSURE APPLIED TO THE BARREL/MUZZLE WILL OPERATE THIS TOOL! DO NOT POINT THIS TOOL AT YOURSELF OR ANY OTHER PERSONS!



©2020 Frontmatec Accles & Shelvoke



DANGER

ONLY COCK THE TOOL READY FOR FIRING IMMEDIATELY BEFORE USE
IF DROPPED WHEN COCKED THIS TOOL COULD CAUSE SERIOUS INJURY OR DEATH





ALWAYS POINT THE TOOL AWAY FROM YOUR BODY AND AWAY FROM ANY OTHER PERSON IN THE VICINITY WHEN HANDLING OR OPERATING THE TOOL

4. FIRE

- 4.1 Hold the assembled tool vertically by the handle
- 4.2 Without touching the animals head align the muzzle of the tool into the correct position above the target animals head
- 4.3 When aligned correctly, tap the tool downward onto the animals head - THE TOOL WILL INSTANTANEOUSLY FIRE - stunning the animal

NOTE

- Refer to section 5 for the correct stunning position and angle for the target animal
- Do not attempt to FIRE if the animal is moving its head
- Once the tool barrel/muzzle is depressed, the tool will fire – it is important the tool is aligned correctly to the target animals head to ensure an effective stun
- If the stun is aborted, remove the cartridge to make the tool safe by removing cartridge strip



DANGER

ONLY COCK THE TOOL READY FOR FIRING IMMEDIATELY BEFORE USE
IF DROPPED WHEN COCKED THIS TOOL COULD CAUSE SERIOUS INJURY OR DEATH





DO NOT ATTEMPT TO USE THIS STUNNING TOOL UNTIL YOU HAVE READ AND UNDERSTOOD THESE INSTRUCTIONS



- ALWAYS WEAR THE CORRECT PERSONAL PROTECTIVE EQUIPMENT (PPE) WHENEVER YOU ARE WORKING WITH, CLEANING OR MAINTAINING YOUR **CASH®** MULTI STUNNER TOOL
- ALWAYS WEAR PROTECTIVE GLASSES AND HEARING PROTECTION. THE CORRECT FOOT PROTECTION MUST BE WORN THERE IS A RISK THAT IF THE TOOL IS DROPPED, THE BOLT MAY PENETRATE THE FOOT OF THE TOOL USER

Part no.	Description	Qty per set
4291	Muzzle spanner	1
5411	Breech cleaner	1
5373	Extractor tool	1
5357	Undercut cleaner	1
4187	**CASH® pistol oil	1
4192	**Cupaslip thread grease	1
6076	**Young's 303 fluid	1
5900	Handle	1
5901	Chamber brush (.22)#	1
5903	Wool mop (.22)#	1
5902	Chamber brush (.25)#	1
5904	Wool mop (.25)#	1



- USE RUBBER GLOVES IF NEEDED OR WHEN REQUIRED

NOTES

Items highlighted above are included with every **CASH®** Multi Stunner

The non-highlighted items are available as maintenance spares

** Product Data Sheets available upon request

Brush and mop supplied in accordance with the calibre of tool

MAINTENANCE AND CLEANING RECORD

It is a requirement of EU Council Regulation (EC) number 1099/2009 On the Protection of Animals at the Time of Killing, that all stunning equipment is maintained in accordance with the manufacturers' instructions and that a log detailing the maintenance is recorded and available for external auditing purposes. We recommend you create a maintenance and cleaning record for each individual stunning tool, containing as a minimum the following information.

- Stunning product code and description
- Serial number
- Service start date (date tool was first used)
- Part replacement details - part number and description - date replacement/maintenance took place
- Stun check record - Universal Stun Check unit serial number, date checked, cartridge colour used, pass or fail
- Shots fired - total number of shots fired with the tool on a daily or weekly basis
- Name and position of person conducting the cleaning or maintenance on any given day

ONLY EVER USE GENUINE ACCLES & SHELVOKE REPLACEMENT PARTS. NOT USING GENUINE PARTS MAY LEAD TO PREMATURE COMPONENT AND TOOL FAILURE, WHICH COULD ENDANGER THE OPERATOR AND THOSE IN THE IMMEDIATE VICINITY. IT WILL ALSO INVALIDATE OUR ORIGINAL EQUIPMENT WARRANTY.

ACCLES & SHELVOKE WILL ACCEPT NO LIABILITY IF ANY COMPONENTS OTHER THAN THOSE SUPPLIED BY ACCLES & SHELVOKE ARE USED WITH OUR ORIGINAL EQUIPMENT. THE RESULTANT LIABILITY WILL BE WITH THE END USER OR THE DISTRIBUTOR WHO SUPPLIED THE UNAPPROVED REPLACEMENT PARTS.

IT IS RECOMMENDED THAT YOUR ACCLES & SHELVOKE STUNNER BE TESTED AND CERTIFICATED ANNUALLY BY THE MANUFACTURER OR BY AN APPROVED DISTRIBUTOR.



ALWAYS POINT THE TOOL AWAY FROM YOUR BODY AND AWAY FROM ANY OTHER PERSON IN THE VICINITY WHEN HANDLING OR OPERATING THE TOOL

CLEANING DAILY - CASH® Multi Stunner

1. Unscrew muzzle from barrel - **NOTE** If the muzzle is too tight and will not unscrew.
2. Withdraw bolt complete with washers and recuperator sleeves from the barrel. **NOTE** The stop washers and some recuperator sleeves may have been retained in the barrel – ensure to REMOVE before cleaning.
3. Clean inside of barrel including undercut with a cloth soaked in pistol oil and followed with the steel brush end of cleaning tool.
4. Wipe the barrel and breech out with a clean rag.
5. Remove the washers and recuperator sleeves from bolt and wire wheel or brush powder residue from piston end of bolt - wipe with cloth when clean. Wipe any residue from recuperator sleeves and washers and examine for wear.
 - 6.1 Stop washer - Red Colour - There are three of these washers at the poleaxe (front) end of the bolt, which fit against the front internal end of the barrel. They protect the recuperator sleeves and as soon as they show signs of wear on either the inside or outside diameter, they should be replaced.
 - 6.2 Flange Washer - Blue Colour - This washer is placed behind the last recuperator sleeve against the bolt flange. As soon as the washer shows signs of wear on the outside edge, it should be replaced.
 - 6.3 Recuperator sleeves - A full set comprises eight sleeves. Number 1 and 8 on the bolt will be the first to show signs of wear. They should be repositioned into a middle position. Once they become badly worn and start to fray, they should be replaced.



DO NOT NEGLECT THE BUFFERS. TOOL PERFORMANCE WILL BE DIMINISHED IF THESE PARTS ARE NOT IN GOOD CONDITION

6. Chamber Cleaning - Assemble the chamber brush shown in Fig. 8.01 and the chamber mop shown in fig. 8.02 to the brush and mop handle fig 8.03, screwing together hand tight. Using the brush end, insert via the open barrel end, into the cartridge chamber, and with a turning action, push in and out of the chamber to remove all powder residue. Youngs 303 fluid can be used if the powder is difficult to remove. Apply some pistol oil to the mop head. Insert via the open barrel end into the cartridge chamber, and with a turning action, push in and out of the chamber to remove any remaining residue or powder.
7. Clean the inside of the breech cap with a cloth soaked in pistol oil and then wipe dry with a clean cloth.



FIG. 8.01



FIG. 8.02



FIG. 8.03

CLEANING WEEKLY - CASH® Multi Stunner

ADDITIONAL CLEANING AND MAINTENANCE FREQUENCY DEPENDING ON USE, BUT MINIMUM WEEKLY.

The enlarged diameter of the inside the barrel at the breech end, described as the 'undercut', must be kept from filling with powder, otherwise bolt return and stunning power will be effected.

1. Grip the undercut cleaner in a vice in a vertical position.
2. Slide the barrel down the cleaner until the breech face contacts.
3. Apply sideways pressure to the barrel so that the cleaner enters the undercut. Maintaining the pressure, rotate the barrel backwards and forwards two or three times. Turn the barrel through 90° and repeat. Continue this process until the undercut has been cleaned completely.
4. Insert the breech cleaner tool into the barrel and locate the cleaner head into the bore of the breech as shown in fig. 8.04. Turn clockwise at least 3 times to remove any residue. Remove the breech cleaner and tip the barrel to empty any detached residue.

FIG. 8.04

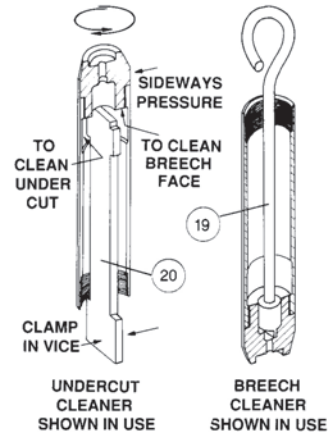

©2019 Frontmatec Accles & Shelvoke



ONLY PERSONNEL WHO HAVE BEEN AUTHORISED TO DO SO SHOULD CONDUCT ANY RECTIFICATION IDENTIFIED IN THIS TROUBLESHOOTING SECTION



- ALWAYS WEAR THE CORRECT PERSONAL PROTECTIVE EQUIPMENT (PPE) WHENEVER YOU ARE WORKING WITH, CLEANING OR MAINTAINING YOUR **CASH®** MULTI STUNNER TOOL
- ALWAYS WEAR PROTECTIVE GLASSES AND HEARING PROTECTION. THE CORRECT FOOT PROTECTION MUST BE WORN THERE IS A RISK THAT IF THE TOOL IS DROPPED, THE BOLT MAY PENETRATE THE FOOT OF THE TOOL USER

SYMPTOMS	CAUSES	ACTION
▪ Cartridge misfires	<ul style="list-style-type: none"> ▪ Firing pin failing to make contact with cartridge ▪ Water or oil-contaminated cartridges ▪ Oil in cartridge chamber 	<ul style="list-style-type: none"> ▪ If no indent is visible on the cartridge head, refer to corrective procedure on the next page ▪ Use a new box of cartridges ▪ Remove oil and clean the chamber
▪ Bolt does not return fully into the muzzle	<ul style="list-style-type: none"> ▪ Incomplete set of recuperator sleeves and washers ▪ Worn washers and recuperator sleeves ▪ Build-up of carbon deposits on piston, breech and in chamber ▪ Bolt is bent 	<ul style="list-style-type: none"> ▪ Check and make good, as necessary ▪ Check and replace as necessary ▪ Check and remove by cleaning as instructed in section 8 ▪ Replace immediately
▪ Stunner fires, but there is insufficient power to stun the animal (refer to section 5 in this manual, for the physical signs of an effective stun)	<ul style="list-style-type: none"> ▪ Corrosion inside barrel ▪ Incorrect strength of cartridge being used ▪ Incorrect positioning of stunner on animal ▪ Bolt not returning fully to the breech after each shot 	<ul style="list-style-type: none"> ▪ Check and remove if present ▪ Check type of cartridge against product code of stunner and animals being stunned by referring to section 5 in this manual ▪ Check correct stunning position for type of animal being stunned by referring to section 5 in this manual ▪ Check for carbon deposits on bolt, breech or in chamber and remove by cleaning as instructed in section 8 in this manual ▪ Check recuperator sleeves, washers and collars for wear and replace as necessary ▪ Check number of washers, recuperator sleeves and collars, make good as necessary ▪ Replace with new tool
▪ Bolt sticks in animal's head	<ul style="list-style-type: none"> ▪ Bolt is bent ▪ Excessive build up of dirt in tool ▪ Recuperator sleeves excessively worn or missing ▪ Cutting edge of bolt narrower than shaft due to incorrect sharpening 	<ul style="list-style-type: none"> ▪ Replace immediately ▪ Conduct cleaning as instructed in section 8 of this manual ▪ Check and replace as necessary ▪ Replace bolt and sharpen by grinding the inside diameter only
▪ Cartridge stuck or difficult to extract	<ul style="list-style-type: none"> ▪ Split cartridge or damaged cartridge chamber ▪ Cartridge chamber not clean 	<ul style="list-style-type: none"> ▪ Return tool to maintenance department for removal and repair ▪ Refer to corrective procedure on next page ▪ Refer to section 8 for chamber cleaning instructions
▪ Unusually loud noise when fired	<ul style="list-style-type: none"> ▪ Split cartridge 	<ul style="list-style-type: none"> ▪ Check for damaged cartridge chamber/ breech, return to manufacturer for repair ▪ Check that the correct cartridge is being used



ALWAYS POINT THE TOOL AWAY FROM YOUR BODY AND AWAY FROM ANY OTHER PERSON IN THE VICINITY WHEN HANDLING OR OPERATING THE TOOL

SAFE MISFIRE REMOVAL

If the cartridge does not fire, follow the procedure below:

1. Holding the tool with the muzzle pointing away from you or any other person, do nothing and wait for at least 30 seconds before continuing.
2. Pull the cartridge strip out of the stunner.
3. Observe if the cartridge is wet, oily or dirty.
4. Look at the cartridge head - if it has been struck, drop the cartridge into a water-filled metal container to make safe.
5. If there is no indent, follow the corrective procedure below.
6. Clean the cartridge chamber using chamber brush and mop and a soft cloth before testing with a new cartridge.
7. If the tool misfires a second time, remove it from the work area as it requires further investigative work and servicing.

MISFIRE - CORRECTIVE ACTION WHEN THE FIRING PIN DOES NOT STRIKE THE HEAD

If no indent is visible on the cartridge head and referring to section 10 in this manual, strip down the tool and check the condition and operation of the parts.

- Worn or damaged firing pin - replace pin. (See section 10).
- Worn or damaged cartridge chamber - tool has surpassed its expected usage – we recommend the purchase of a new stunning tool.
- Test the tool after every corrective action to make sure that the tool is working correctly before putting back into operation.

TRAPPED OR STUCK CARTRIDGE REMOVAL

To remove a cartridge that is stuck and will not eject using the extractor:

1. Unscrew and remove the assembly collar.
2. Remove the washers, sleeves and bolt.
3. Grip the barrel in a soft jawed vice.
4. Using a push rod of 4.5 mm (3/16") diameter, insert into the breech and gently push out the cartridge through the cartridge chamber.
5. Reassemble using reverse procedure to above.
6. Clean the cartridge chamber with the chamber brush and mop as detailed in section 8 of this manual.
7. If the tool misfires a second time, remove it from the work area as it requires further investigative work and servicing.



DO NOT ATTEMPT TO USE THIS STUNNING TOOL UNTIL YOU HAVE READ AND UNDERSTOOD THESE INSTRUCTIONS



- ALWAYS WEAR THE CORRECT PERSONAL PROTECTIVE EQUIPMENT (PPE) WHENEVER YOU ARE WORKING WITH, CLEANING OR MAINTAINING YOUR **CASH®** MULTI STUNNER TOOL
- ALWAYS WEAR PROTECTIVE GLASSES AND HEARING PROTECTION. THE CORRECT FOOT PROTECTION MUST BE WORN THERE IS A RISK THAT IF THE TOOL IS DROPPED, THE BOLT MAY PENETRATE THE FOOT OF THE TOOL USER
- RUBBER GLOVES SHOULD BE WORN WHEN SERVICING IS NECESSARY



ALWAYS POINT THE TOOL AWAY FROM YOUR BODY AND AWAY FROM ANY OTHER PERSON IN THE VICINITY WHEN HANDLING OR OPERATING THE TOOL

ALL TOOLS AND ACCESSORIES SHOULD BE AT LEAST SERVICED AND CALIBRATED ANNUALLY.

REPLACING FIRING PIN - item 2 in the spare parts list and diagram

1. Remove the centre body from the assembly collar
2. Place only the flats of the firing pin into the extraction tool

REPLACING THE FIRING PIN

1. Replace the firing pin and tighten until it is finger tight
2. Using the firing pin tool, finally tighten with the firing pin tool

REPLACING PHOSPHOR BRONZE BALLS item 3 in spare parts list and diagram REMOVING THE PHOSPHOR BRONZE BALLS

1. Remove the red retainer rings
2. Prise the bottom red O-ring (item 5) from the cap, then repeat the process with the remaining O-ring (once the red O-rings have been removed, we recommend you replace the O-rings)
3. Remove the phosphor bronze balls from the assembly body

REMOVING THE PHOSPHOR BRONZE BALLS

1. Put a small amount of grease on the area where the ball sits in the cap
2. Put the phosphor bronze balls into the greased area
3. Put two new O-rings over the phosphor bronze balls

ONLY USE FOLLOWING LUBRICANTS DURING MAINTENANCE

Item no.	Description
4187	CASH® pistol oil
4192	Copaslip thread grease
6076	Youngs 303 fluid

Frontmatec Accles & Shelvoke provide a comprehensive service and repair facility where customers can have their **CASH®** tool serviced by our highly experienced and trained engineers. This service is generally open to UK customers. Overseas customers are advised to contact their local distributor.

- A quotation will be provided on inspection of the return of the tool, itemising service charges and replacement parts required.
- The service involves the tool being stripped, cleaned and reassembled with the replacement parts quoted to return the tool back to good working order.

Customers are advised to contact Frontmatec Accles & Shelvoke direct on +44(0)121 313 3564 to make arrangements to return the tool for service and repair.

ONLY EVER USE GENUINE ACCLES & SHELVOKE REPLACEMENT PARTS. NOT USING GENUINE PARTS MAY LEAD TO PREMATURE COMPONENT AND TOOL FAILURE, WHICH COULD ENDANGER THE OPERATOR AND THOSE IN THE IMMEDIATE VICINITY. IT WILL ALSO INVALIDATE OUR ORIGINAL EQUIPMENT WARRANTY.

ACCLES & SHELVOKE WILL ACCEPT NO LIABILITY IF ANY COMPONENTS OTHER THAN THOSE SUPPLIED BY ACCLES & SHELVOKE ARE USED WITH OUR ORIGINAL EQUIPMENT. THE RESULTANT LIABILITY WILL BE WITH THE END USER OR THE DISTRIBUTOR WHO SUPPLIED THE UNAPPROVED REPLACEMENT PARTS.

FIG. 11.01

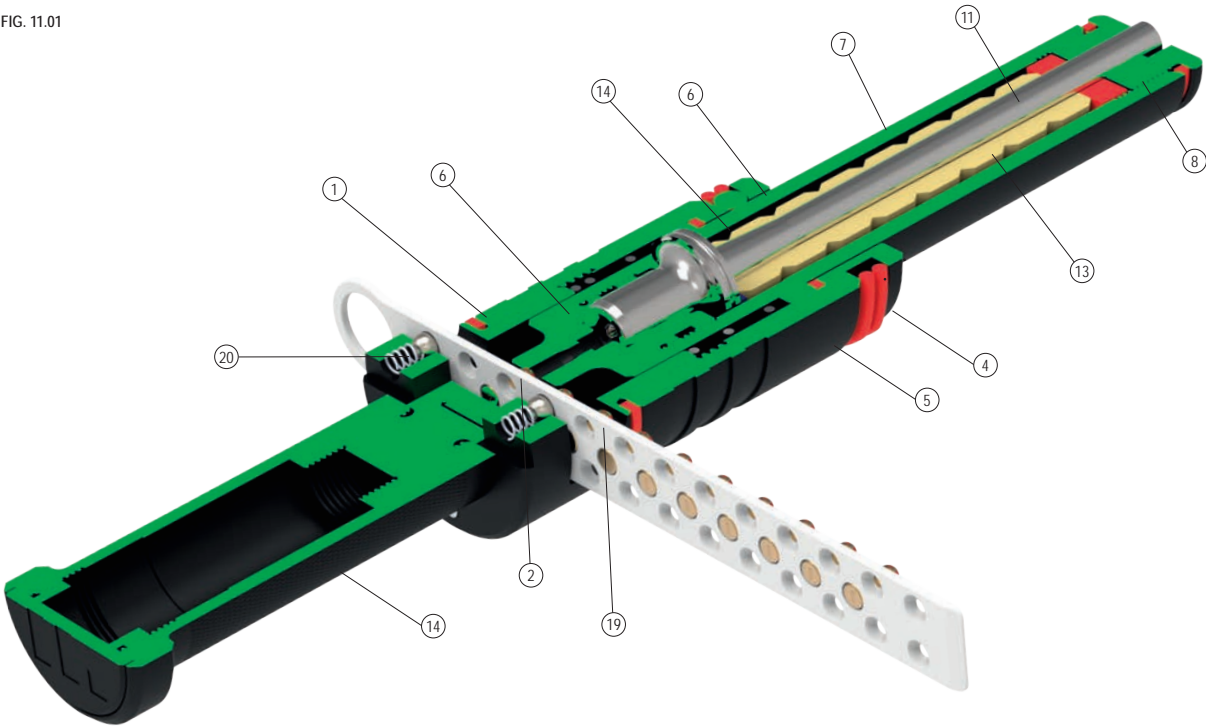

©2019 Frontmate Accles & Shelvoka

Item no.	Part description	Qty per set	SPARE PART BY PRODUCT CODE	IF ORDERING AN ASSEMBLY FOR SPARES, INCLUDES ITEMS LISTED BELOW
			5500	
1	Centre body	1		2, 3, 4, 5
2	Firing pin	1		
3	Phosphor bronze ball	3		
4	O-ring	2		
5	Barrel assembly	1		7, 8, 9
6	Breech	1		
7	Barrel	1		
8	Stop washer	3		
9	Flange washer	1		
10	Lock washer	1		
11	Bolt	1		
12	Muzzle	1		
13	Recuperator sleeves	8		
14	Handle cap assembly	1		17, 18
15	Breech cleaner	1		
16	Undercut cleaner	1		
17	Muzzle spanner	1		
18	Extrator	1		
19	Ratchet ball	4		
20	Ratchet spring	4		

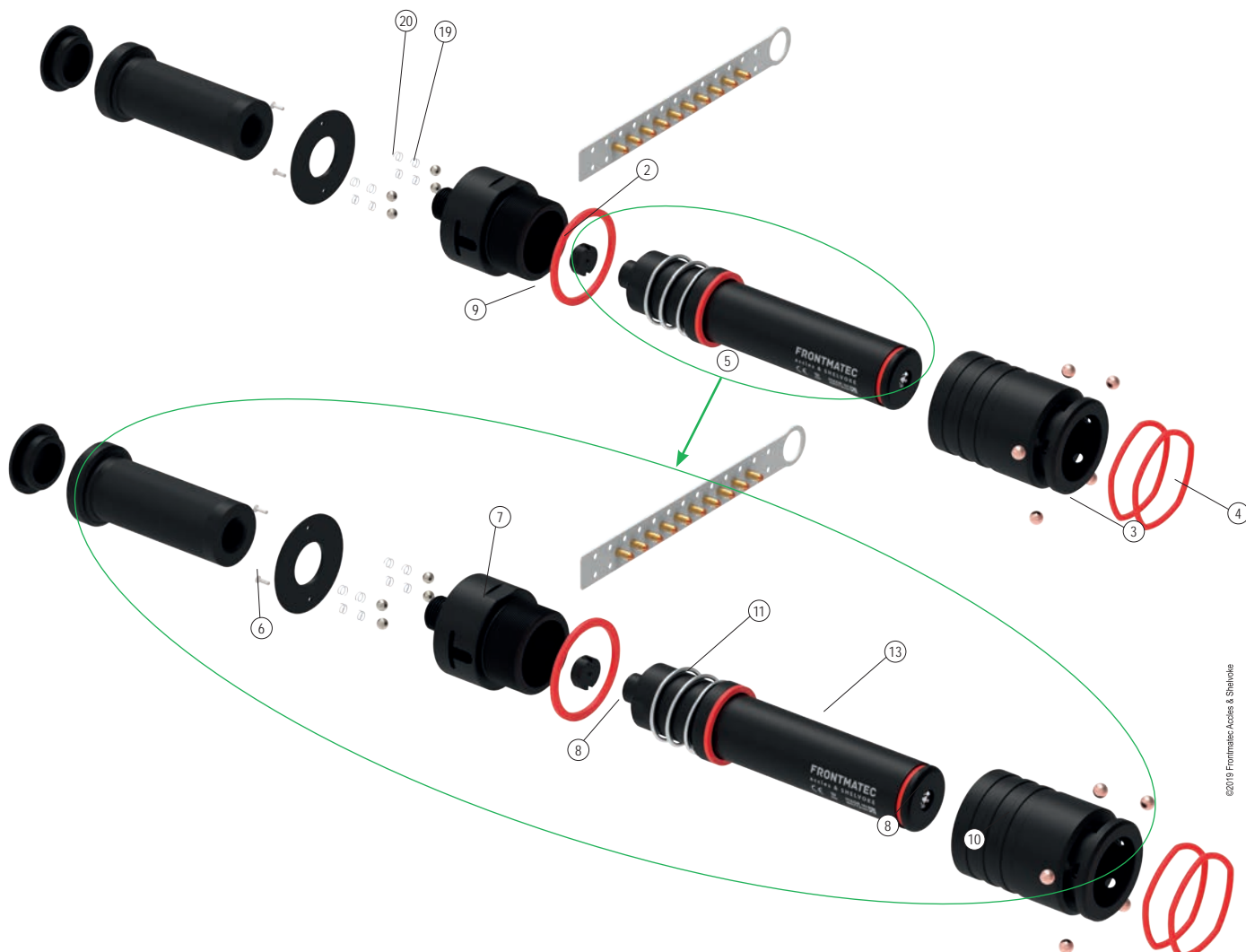
CASH® Multi Stunner
SPARE PARTS LIST AND DIAGRAM
FRONTMATEC
accles & SHELVOKE

©2019 Frontmatec Accles & Shelvoke

Item no.	Part description	Qty per set	SPARE PART BY PRODUCT CODE	IF ORDERING AN ASSEMBLY FOR SPARES, INCLUDES ITEMS LISTED BELOW
			5500	
1	Centre body	1		2, 3, 4, 5
2	Firing pin	1		
3	Phospher bronze ball	3		
4	O-ring	2		
5	Barrel assembly	1		7, 8, 9
6	Breech	1		
7	Barrel	1		
8	Stop washer	3		
9	Flange washer	1		
10	Lock washer	1		
11	Bolt	1		
12	Muzzle	1		
13	Recuperator sleeves	8		
14	Handle cap assembly	1		17, 18
15	Breech cleaner	1		
16	Undercut cleaner	1		
17	Muzzle spanner	1		
18	Extrator	1		
19	Rachet ball	4		
20	Rachet spring	4		

Contact us today to find out how Accles & Shelvoke can help your current or future stunning requirements.

For customers based in Canada and USA:

Frontmatec Accles & Shelvoke Ltd
73 Victory Highway, West Greenwich
Rhode Island 02817
USA

Phone: +1 800 396 9497
Fax: +1 401 397 5031
E-mail: birmingham@frontmatec.com
accles-shelvoke.com
frontmatec.com

For all other customers:

Frontmatec Accles & Shelvoke Ltd
Unit 5A, Maybrook Road, Maybrook Business Park
Minworth Sutton Coldfield
Birmingham, West Midlands
UK B76 1 AL

Phone: +44 121 313 3564
Fax: +44 121 313 0282
E-mail: birmingham@frontmatec.com
accles-shelvoke.com
frontmatec.com

WARRANTY

The Accles & Shelvoke product warranty policy is available upon request. The product warranty policy, like any other, is conditional.

Your tool has been assembled, tested and proof-stamped as a mark of its performance, quality and safety, and arrives with you in full working order.

Your **CASH®** Multi Stunner has been designed and developed over 100 years of experience in the meat processing industry. It has proven to be a very reliable and robust tool if cleaned and maintained in accordance with this instruction manual.

In the event of any problems, please contact your local distributor.

RECYCLING

Once any component or tool has surpassed its useful life, it needs to be disposed of in a responsible manner. Most of the materials from which the Accles & Shelvoke range of stunning tools is manufactured can be recycled.

These materials must be correctly separated before they can be recycled. To do so, disassemble the tool, and sort into the groups highlighted in the table below. Use the spare parts list and diagram (section 11) to help with identification.

The disassembled and sorted items may be disposed of at an appropriate recycling facility.

Items/parts	Main material	Disposal
All components itemised in the <i>Spare Parts List and Diagram</i> except those detailed below	Steel	Ferrous metal recycling
5, 10, 11, 12, 15	Rubber	General waste
Spent cartridges	Brass	Non-ferrous metal recycling
Packaging cardboard	Cardboard	Cardboard recycling
Packaging plastic	Plastic	Plastics recycling
Other non-specified items	Various	General waste

**DECLARATION OF CONFORMITY**

Accles & Shelvoke Ltd instruction manual - Issue 3 Part no. 5530 V4-5

Manufacturer name	Frontmatec Accles & Shelvoke		Machinery covered by this declaration
Full address	Unit 5A Maybrook Road Maybrook Business Park Minworth, Sutton Coldfield Birmingham, West Midlands, UK B76 1AL	Description	CASH® Multi Stunner range of captive bolt stunning tools
Full list of products declared under this certificate number		Function	For the stunning of livestock prior to slaughter or depopulation
		Product code of stunner supplied with instruction manual	NOTE APPLY PRODUCT CODE & PRODUCT DESCRIPTION LABEL HERE
		Product description	
		Serial number	NOTE APPLY SERIAL NUMBER LABEL HERE

he machinery conforms to all the requirements of the Machinery Directive 2006/42/EC

The machinery also conforms to the following Directives and UK Laws	EU Council Regulation (EC) No 1099/2009 on the protection of animals at the time of killing; The Gun Barrel Proof Act 1978		
The following standards have been used	EN ISO 12100:2010		
Notified body who carried out the EC type examination or Full Quality Assurance	Name		
	Address	amtri veritas ltd, veritas house, pierce street, macclesfield sk11 6er	
	Notified body no.	0463	Certificate no.: AVEC 3847-3

The technical file is compiled in accordance with part A of Annex VII of the Machinery Directive 2006/42/EC

Person authorised to compile the technical file (based in the European Community)	Name	Steve West - Manufacturing Manager
	Address	Refer to company address above

The relevant authorised person undertakes to transmit, in response to a reasoned request by the national authorities, relevant information on the machinery. This information will be transmitted by: e-mail

Person authorised to make this declaration	Name	Joe Holland
	Position in company	Vice President of Bolt Stunning
	Signature	
	Place of declaration	Unit 5A, Maybrook Road, Maybrook Business Park, Minworth Sutton Coldfield, Birmingham, West Midlands, UK B76 1AL
	Date of declaration	1 st May 2017